

TECHNICAL DATA

802 Series V

installed sound reinforcement loudspeaker

Product Overview

One of the best-selling sound reinforcement loudspeakers of all time returns. The Bose Professional 802 Series V features eight 4.5-inch full-range drivers that deliver smooth frequency response, wide dispersion, and exceptional power handling and efficiency. The proprietary array design ensures a wide 120° × 100° coverage pattern, reducing the need for multiple loudspeakers, while the 52 Hz low-frequency range can eliminate the need for subwoofers. The rugged, lightweight enclosure is IP55 weather-rated for durability in indoor and outdoor installations, and flexible mounting options allow for easy, secure installations in various configurations.

Available in black, 802 Series V is compatible with the 802 U-Bracket and WBP-8 wall-mount adapter.



Key Features

Eight 4.5-inch full-range drivers deliver smooth frequency response, wide dispersion, and exceptional power handling and efficiency

Proprietary array design ensures a wide 120° × 100° coverage pattern, reducing the need for multiple loudspeakers

52 Hz – 15 kHz frequency range provides full-range audio without the need for subwoofers at moderate sound levels

High 123 dB peak SPL capacity means powerful sound reinforcement in demanding environments

Rugged, lightweight enclosure is IP55 weather-rated for durability in indoor and outdoor installations

Flexible mounting options including threaded inserts for easy, secure installations in various configurations

Applications

Hospitality

Retail / restaurants

Corporate

Houses of worship

Performing arts

Education

TECHNICAL DATA

802 Series V

installed sound reinforcement loudspeaker

Technical Specifications

SINGLE-LOUDSPEAKER PERFORMANCE		
Frequency Range (-10 dB) ¹	52 Hz – 15,000 Hz	
Nominal Coverage Pattern	120° horizontal × 100° vertical	
	AES Transducer Test ⁴	Bose Professional Extended-Lifecycle Test ⁵
Power Handling, Long-term Continuous	300 W	240 W
Power Handling, Peak	1200 W	960 W
Sensitivity (SPL / 1 W @ 1 m) ²	92 dB	92 dB
Calculated Maximum SPL @ 1 m, Continuous ³	117 dB	116 dB
Calculated Maximum SPL @ 1 m, Peak	123 dB	122 dB
Loudspeaker EQ	Active EQ required for optimal performance	
Recommended High-pass Protection	55 Hz with minimum 12-dB/octave filter	
Overload Protection	Power-limiting circuit, non-fused, automatic reset	
TRANSDUCERS		
Drivers	8 × Bose Professional 4.5-in (114 mm) full-range cone transducers	
Nominal Impedance	8 Ω	
PHYSICAL		
Enclosure Material	Mineral-reinforced HDPE	
Grille	Powder-coated steel	
Environmental	Outdoors or indoors, IP55 per IEC 60529:2013+COR.1:2019	
Connectors	(2) Neutrik® NL4 wired parallel	
Suspension / Mounting	(8) M8 threaded inserts (2 back, 2 bottom, 4 sides)	
Product Dimensions (length × width × depth)	334 mm × 523 mm × 318 mm (13.1 in × 20.5 in × 12.5 in)	
Net Weight	16.7 kg (36.8 lb)	
Shipping Weight	19.3 kg (42.5 lb)	
Package Contents	(1) 802 Series V, (1) installation guide	
Accessories	802 U-bracket, WBP-8 bi-pivot bracket	
PRODUCT CODES		
802 Series V, black	893554-0100 802 SERIES V OUTDOOR INSTLD LDSPK BLK	
802 U-bracket	746686-0110 802 U-BRACKET BLK	
WBP-8 bi-pivot bracket	893802-0100 WBP-8 PAN & TILT WALL BRACKET, BLK	

Footnotes

1. Frequency range measured on-axis with recommended EQ in an anechoic environment.
2. Sensitivity measured in anechoic acoustic boundary conditions with recommended EQ, referenced to 1 W/m.
3. Maximum SPL calculated from sensitivity and power handling specifications exclusive of power compression.
4. AES component test: pink noise, IEC 268-5 filtered, 6-dB crest factor, 2-hour duration with recommended EQ.
5. Bose extended-lifecycle test: pink noise, IEC 268-5 filtered, 6-dB crest factor, 100-hour duration with recommended EQ.

For additional specifications and application information, visit BoseProfessional.com. Specifications are subject to change. 12/2024

TECHNICAL DATA

802 Series V

installed sound reinforcement loudspeaker

On-axis Response

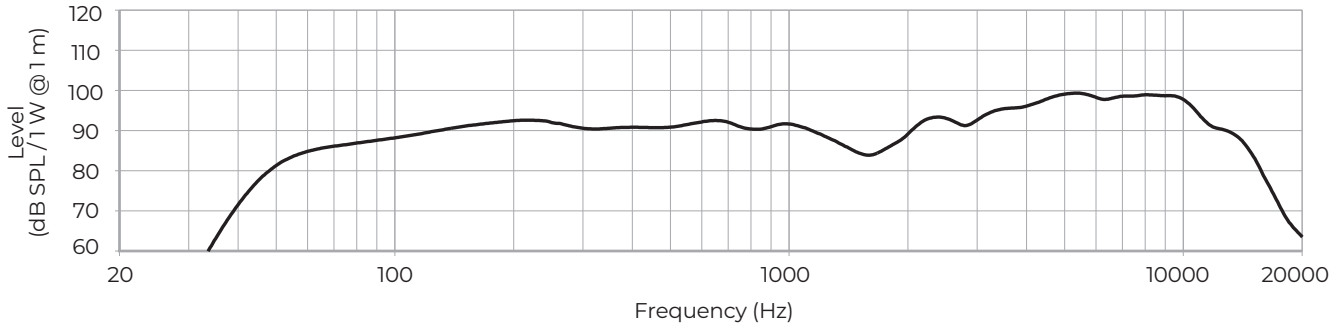

Impedance

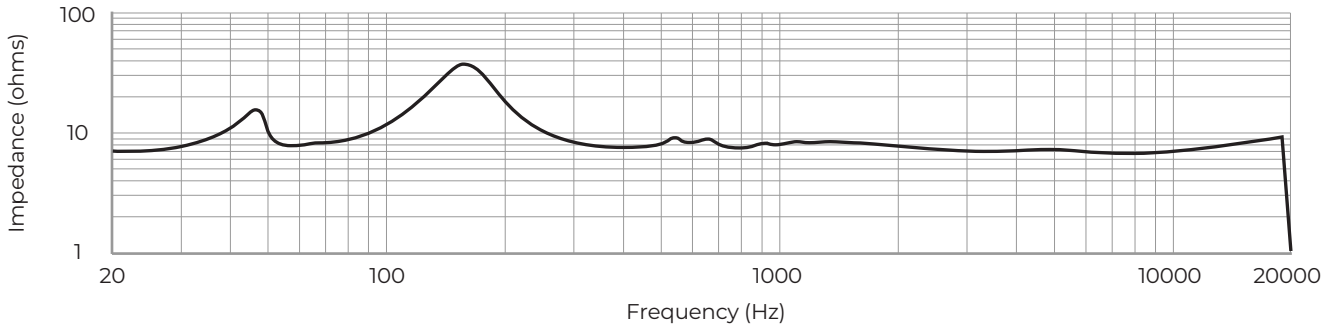

Beamwidth

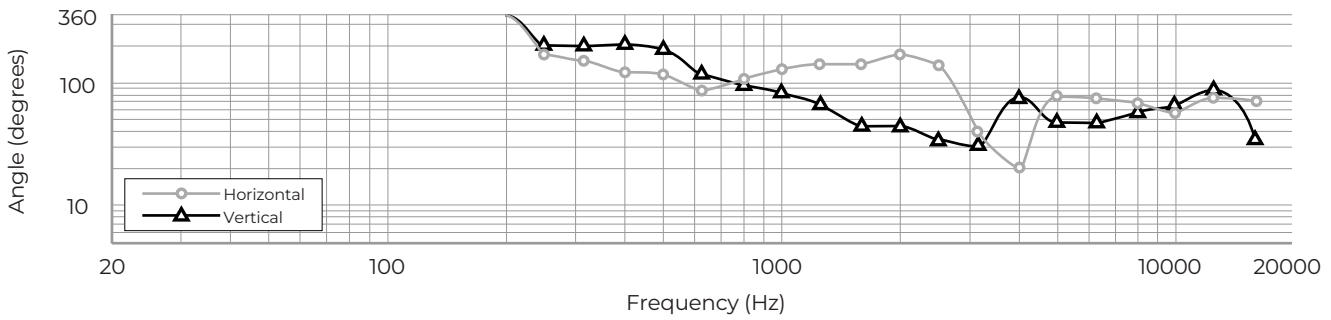

For additional specifications and application information, visit BoseProfessional.com. Specifications are subject to change. 12/2024

TECHNICAL DATA

802 Series V

installed sound reinforcement loudspeaker

Dimensions ⁶

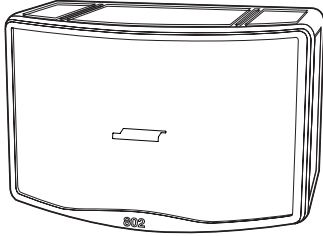

Side View ⁷

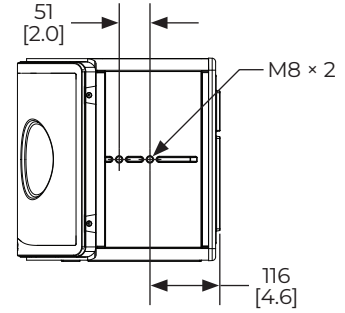

Front View

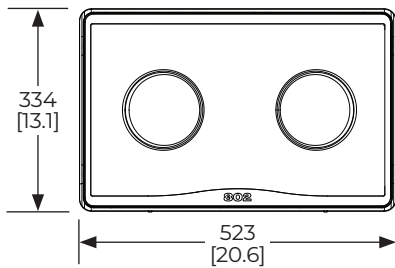

Rear View

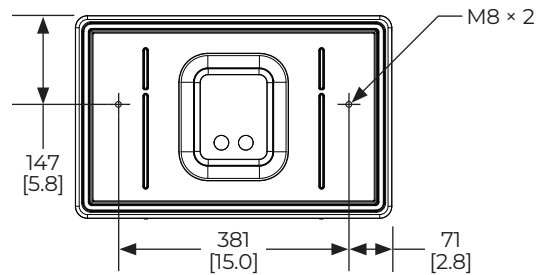

Bottom View

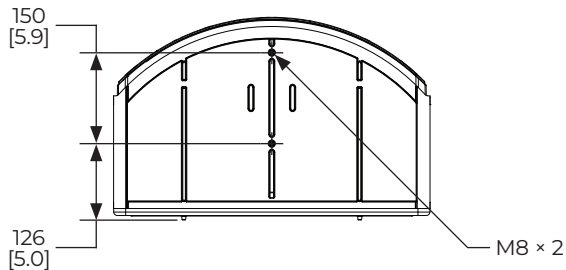

Top View

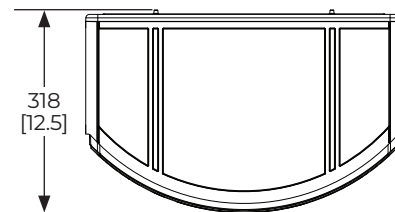

6. Dimensions are shown in millimeters over inches.
7. Dimensions apply to both left and right sides.

© 2024 Transom Post OpCo LLC. All rights reserved. 802 is a trademark of Transom Post OpCo LLC. Bose is a trademark of Bose Corporation. Neutrik is a registered trademark of Neutrik AG. All other trademarks are the property of their respective owners.

For additional specifications and application information, visit BoseProfessional.com. Specifications are subject to change. 12/2024